



## Applications

Hooks are used in lifting systems as a connection between the load to be lifted and the wire rope or chain slings.

## Range

Van Beest offers a range of hooks, from drop forged carbon steel eye hooks to drop forged alloy steel swivel hooks, which are quenched and tempered.

Van Beest can also offer other types of lifting hooks in grade 8, grade 10 and stainless steel. Please refer to the EXCEL<sup>®</sup> section in this catalogue for more information.

## Design

There are different types of hooks with specific designs to suit various purposes. Eye hooks and swivel hooks are designed to be used with wire rope or chain. Pipe line hooks are designed for easy handling of tubes.

Most types of hooks are supplied with a safety latch.

All types of hooks are generally marked with:

- |                         |               |
|-------------------------|---------------|
| - Working Load Limit    | ■ e.g. 5.4 t  |
| - manufacturer's symbol | ■ e.g. GP     |
| - traceability code     | ■ e.g. H-AB   |
| - steel grade           | ■ e.g. 4 or 8 |

## Finish

Grade 8 hooks are painted red, grade 4 hooks are painted green.

## Certification

Specific details of certificate availability can be found on each product page. Please verify your certification requirements with Van Beest at time of order.

## Instructions for use

Hooks should be inspected before use to ensure that:

- all markings are legible;
- a hook with the correct WLL has been selected. For further details we refer to EN 818 standard for Chain Slings;
- the latch is present;
- the latch is functional;
- the bolt, nut or any other locking system cannot vibrate out of position;
- the hook is never side-, tip- or back- loaded;
- swivel hooks may not rotate under load;
- always make sure that the hook is supporting the load correctly;
- the latch should not be supporting any load;
- hooks are free from nicks, gouges and cracks;
- hooks may not be heat treated as this may affect their WLL;
- never modify, repair or reshape a hook by machining, welding, heating or bending as this may affect the WLL.

Hooks must be regularly inspected in accordance with the safety standards given in the country of use. This is required because the products in use may be affected by wear, misuse, overloading etc. which may lead to deformation and alteration of the material structure.

Inspection should take place at least every six months and more frequently when the hooks are used in severe operating conditions.



P-6714C

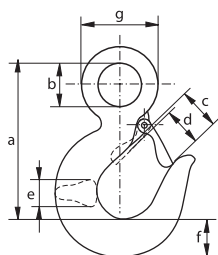

## Green Pin® large eye hooks, Grade 4 with safety latch

- **Material** : carbon steel, Grade 4
- **Safety factor** : MBL equals 5 x WLL
- **Standard** : generally to EN 1677-5
- **Finish** : painted green
- **Certification** : 2.1 2.2 3.1

working load limit	length	diameter eye inside	width opening	width opening	thickness	width	diameter eye outside	weight each
t	a mm	b mm	c mm	d mm	e mm	f mm	g mm	kg
0.8	81	19	24	20	16	19	37	0.27
1	91	22	26	22	18	22	45	0.4
1.6	105	27	32	27	20	27	52	0.64
2	124	32	34	30	24	31	62	1.08
3.2	147	39	44	37	31	36	74	1.68
5	190	50	55	48	37	48	96	3.75

In inch

working load limit	length	diameter eye inside	width opening	width opening	thickness	width	diameter eye outside	weight each
t	a inch	b inch	c inch	d inch	e inch	f inch	g inch	lbs
0.8	3 <sup>3</sup> / <sub>16</sub>	<sup>3</sup> / <sub>4</sub>	<sup>15</sup> / <sub>16</sub>	<sup>25</sup> / <sub>32</sub>	<sup>5</sup> / <sub>8</sub>	<sup>3</sup> / <sub>4</sub>	1 <sup>1</sup> / <sub>2</sub>	0.6
1	3 <sup>19</sup> / <sub>32</sub>	<sup>7</sup> / <sub>8</sub>	1 <sup>1</sup> / <sub>32</sub>	<sup>7</sup> / <sub>8</sub>	<sup>23</sup> / <sub>32</sub>	<sup>7</sup> / <sub>8</sub>	1 <sup>25</sup> / <sub>32</sub>	0.88
1.6	4 <sup>1</sup> / <sub>8</sub>	1 <sup>3</sup> / <sub>32</sub>	1 <sup>9</sup> / <sub>32</sub>	1 <sup>3</sup> / <sub>32</sub>	<sup>25</sup> / <sub>32</sub>	1 <sup>3</sup> / <sub>32</sub>	2 <sup>1</sup> / <sub>32</sub>	1.32
2	4 <sup>7</sup> / <sub>8</sub>	1 <sup>9</sup> / <sub>32</sub>	1 <sup>11</sup> / <sub>32</sub>	1 <sup>3</sup> / <sub>16</sub>	<sup>15</sup> / <sub>16</sub>	1 <sup>1</sup> / <sub>4</sub>	2 <sup>7</sup> / <sub>16</sub>	2.16
3.2	5 <sup>25</sup> / <sub>32</sub>	1 <sup>9</sup> / <sub>16</sub>	1 <sup>3</sup> / <sub>4</sub>	1 <sup>1</sup> / <sub>2</sub>	1 <sup>1</sup> / <sub>4</sub>	1 <sup>7</sup> / <sub>16</sub>	2 <sup>29</sup> / <sub>32</sub>	3.7
5	7 <sup>1</sup> / <sub>2</sub>	1 <sup>31</sup> / <sub>32</sub>	2 <sup>5</sup> / <sub>32</sub>	1 <sup>29</sup> / <sub>32</sub>	1 <sup>1</sup> / <sub>2</sub>	1 <sup>29</sup> / <sub>32</sub>	3 <sup>25</sup> / <sub>32</sub>	7.94



P-6714A

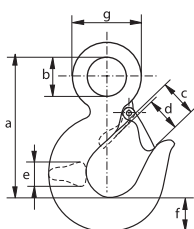

## Green Pin® large eye hooks, Grade 8 with safety latch

- **Material** : alloy steel, Grade 8
- **Safety factor** : MBL equals 4 x WLL
- **Standard** : generally to EN 1677-2
- **Finish** : painted red
- **Certification** : 2.1 2.2 3.1

working load limit	length	diameter eye inside	width opening	width opening	thickness	width	diameter eye outside	weight each
t	a mm	b mm	c mm	d mm	e mm	f mm	g mm	kg
1.25	81	19	24	20	16	19	37	0.3
1.6	91	22	26	22	18	22	45	0.44
2.5	105	27	32	27	20	27	52	0.63
3.2	124	32	34	30	24	31	62	1.27
5.4	147	39	44	37	31	36	74	1.76
8.2	190	50	55	48	37	48	96	3.6
12.8	230	64	64	53	48	61	126	7.7
16	254	70	70	60	58	69	139	10.8
22	316	89	91	77	63	81	169	16.7

In inch

working load limit	length	diameter eye inside	width opening	width opening	thickness	width	diameter eye outside	weight each
t	a inch	b inch	c inch	d inch	e inch	f inch	g inch	lbs
1.25	3 <sup>3</sup> / <sub>16</sub>	<sup>3</sup> / <sub>4</sub>	<sup>15</sup> / <sub>16</sub>	<sup>25</sup> / <sub>32</sub>	<sup>5</sup> / <sub>8</sub>	<sup>3</sup> / <sub>4</sub>	1 <sup>1</sup> / <sub>2</sub>	0.66
1.6	3 <sup>19</sup> / <sub>32</sub>	<sup>7</sup> / <sub>8</sub>	1 <sup>1</sup> / <sub>32</sub>	<sup>7</sup> / <sub>8</sub>	<sup>23</sup> / <sub>32</sub>	<sup>7</sup> / <sub>8</sub>	1 <sup>25</sup> / <sub>32</sub>	0.97
2.5	4 <sup>1</sup> / <sub>8</sub>	1 <sup>3</sup> / <sub>32</sub>	1 <sup>9</sup> / <sub>32</sub>	1 <sup>3</sup> / <sub>32</sub>	<sup>25</sup> / <sub>32</sub>	1 <sup>3</sup> / <sub>32</sub>	2 <sup>1</sup> / <sub>32</sub>	1.39
3.2	4 <sup>7</sup> / <sub>8</sub>	1 <sup>9</sup> / <sub>32</sub>	1 <sup>11</sup> / <sub>32</sub>	1 <sup>3</sup> / <sub>16</sub>	<sup>15</sup> / <sub>16</sub>	1 <sup>1</sup> / <sub>4</sub>	2 <sup>7</sup> / <sub>16</sub>	2.80
5.4	5 <sup>25</sup> / <sub>32</sub>	1 <sup>9</sup> / <sub>16</sub>	1 <sup>3</sup> / <sub>4</sub>	1 <sup>1</sup> / <sub>2</sub>	1 <sup>1</sup> / <sub>4</sub>	1 <sup>7</sup> / <sub>16</sub>	2 <sup>29</sup> / <sub>32</sub>	3.88
8.2	7 <sup>1</sup> / <sub>2</sub>	1 <sup>31</sup> / <sub>32</sub>	2 <sup>5</sup> / <sub>32</sub>	1 <sup>29</sup> / <sub>32</sub>	1 <sup>1</sup> / <sub>2</sub>	1 <sup>29</sup> / <sub>32</sub>	3 <sup>25</sup> / <sub>32</sub>	7.94
12.8	9 <sup>3</sup> / <sub>32</sub>	2 <sup>17</sup> / <sub>32</sub>	2 <sup>17</sup> / <sub>32</sub>	2 <sup>3</sup> / <sub>32</sub>	1 <sup>29</sup> / <sub>32</sub>	2 <sup>3</sup> / <sub>8</sub>	4 <sup>15</sup> / <sub>16</sub>	16.98
16	10	2 <sup>3</sup> / <sub>4</sub>	2 <sup>3</sup> / <sub>4</sub>	2 <sup>11</sup> / <sub>32</sub>	2 <sup>9</sup> / <sub>32</sub>	2 <sup>23</sup> / <sub>32</sub>	5 <sup>1</sup> / <sub>2</sub>	23.8
22	12 <sup>7</sup> / <sub>16</sub>	3 <sup>17</sup> / <sub>32</sub>	3 <sup>19</sup> / <sub>32</sub>	3 <sup>1</sup> / <sub>32</sub>	2 <sup>1</sup> / <sub>2</sub>	3 <sup>3</sup> / <sub>16</sub>	6 <sup>5</sup> / <sub>8</sub>	36.8

## Green Pin® swivel hooks, Grade 8

### with safety latch

- **Material** : alloy steel, Grade 8
- **Safety factor** : MBL equals 4 x WLL
- **Finish** : painted red
- **Certification** : **2.1** **2.2** **3.1**



P-6703A

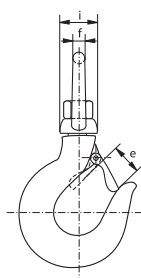
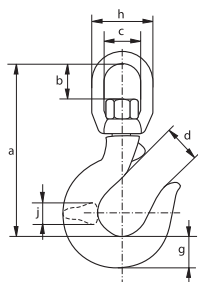

working load limit	length	length inside	width inside	width opening	width opening	diameter	width	width	width	thickness	weight each
t	a mm	b mm	c mm	d mm	e mm	f mm	g mm	h mm	i mm	j mm	kg
1.25	118	28	31	24	20	11	19	52	30	16	0.49
1.6	145	35	40	26	22	14	23	68	37	18	0.95
2.5	167	43	47	32	27	17	27	81	43	20	1.48
3.2	180	47	47	34	30	17	31	81	43	24	1.79
5.4	217	54	64	44	37	21	37	106	64	31	3.8
8.2	276	69	78	55	48	26	48	130	77	37	7.4
11.5	310	68	82	58	53	22	60	136	82	43	9.7
16	352	84	92	66	58	24	67	154	92	52	14.9
22	434	107	115	87	78	29	80	191	108	64	27
31.5	512	117	132	97	87	34	94	222	132	80	46

In inch

working load limit	length	length inside	width inside	width opening	width opening	diameter	width	width	width	thickness	weight each
t	a inch	b inch	c inch	d inch	e inch	f inch	g inch	h inch	i inch	j inch	lbs
1.25	4 <sup>5</sup> / <sub>8</sub>	1 <sup>1</sup> / <sub>8</sub>	1 <sup>1</sup> / <sub>4</sub>	<sup>15</sup> / <sub>16</sub>	<sup>25</sup> / <sub>32</sub>	<sup>7</sup> / <sub>16</sub>	<sup>3</sup> / <sub>4</sub>	2 <sup>1</sup> / <sub>32</sub>	1 <sup>3</sup> / <sub>16</sub>	<sup>5</sup> / <sub>8</sub>	1.08
1.6	5 <sup>23</sup> / <sub>32</sub>	1 <sup>3</sup> / <sub>8</sub>	1 <sup>19</sup> / <sub>32</sub>	1 <sup>1</sup> / <sub>32</sub>	<sup>7</sup> / <sub>8</sub>	<sup>9</sup> / <sub>16</sub>	<sup>29</sup> / <sub>32</sub>	2 <sup>11</sup> / <sub>16</sub>	1 <sup>1</sup> / <sub>2</sub>	<sup>23</sup> / <sub>32</sub>	2.09
2.5	6 <sup>9</sup> / <sub>16</sub>	1 <sup>23</sup> / <sub>32</sub>	1 <sup>7</sup> / <sub>8</sub>	1 <sup>9</sup> / <sub>32</sub>	1 <sup>3</sup> / <sub>32</sub>	<sup>11</sup> / <sub>16</sub>	1 <sup>3</sup> / <sub>32</sub>	3 <sup>3</sup> / <sub>16</sub>	1 <sup>23</sup> / <sub>32</sub>	<sup>25</sup> / <sub>32</sub>	3.26
3.2	7 <sup>3</sup> / <sub>32</sub>	1 <sup>7</sup> / <sub>8</sub>	1 <sup>7</sup> / <sub>8</sub>	1 <sup>11</sup> / <sub>32</sub>	1 <sup>3</sup> / <sub>16</sub>	<sup>11</sup> / <sub>16</sub>	1 <sup>1</sup> / <sub>4</sub>	3 <sup>3</sup> / <sub>16</sub>	1 <sup>23</sup> / <sub>32</sub>	<sup>15</sup> / <sub>16</sub>	3.95
5.4	8 <sup>9</sup> / <sub>16</sub>	2 <sup>1</sup> / <sub>8</sub>	2 <sup>17</sup> / <sub>32</sub>	1 <sup>3</sup> / <sub>4</sub>	1 <sup>1</sup> / <sub>2</sub>	<sup>13</sup> / <sub>16</sub>	1 <sup>1</sup> / <sub>2</sub>	4 <sup>5</sup> / <sub>32</sub>	2 <sup>17</sup> / <sub>32</sub>	1 <sup>1</sup> / <sub>4</sub>	8.38
8.2	10 <sup>7</sup> / <sub>8</sub>	2 <sup>23</sup> / <sub>32</sub>	3 <sup>3</sup> / <sub>32</sub>	2 <sup>5</sup> / <sub>32</sub>	1 <sup>15</sup> / <sub>16</sub>	1 <sup>1</sup> / <sub>32</sub>	1 <sup>29</sup> / <sub>32</sub>	5 <sup>1</sup> / <sub>8</sub>	3 <sup>1</sup> / <sub>32</sub>	1 <sup>1</sup> / <sub>2</sub>	16.31
11.5	12 <sup>3</sup> / <sub>16</sub>	2 <sup>11</sup> / <sub>16</sub>	3 <sup>1</sup> / <sub>4</sub>	2 <sup>9</sup> / <sub>32</sub>	2 <sup>3</sup> / <sub>32</sub>	<sup>7</sup> / <sub>8</sub>	2 <sup>11</sup> / <sub>32</sub>	5 <sup>11</sup> / <sub>32</sub>	3 <sup>1</sup> / <sub>4</sub>	1 <sup>23</sup> / <sub>32</sub>	21.38
16	13 <sup>7</sup> / <sub>8</sub>	3 <sup>5</sup> / <sub>16</sub>	3 <sup>5</sup> / <sub>8</sub>	2 <sup>19</sup> / <sub>32</sub>	2 <sup>9</sup> / <sub>32</sub>	<sup>15</sup> / <sub>16</sub>	2 <sup>5</sup> / <sub>8</sub>	6 <sup>1</sup> / <sub>32</sub>	3 <sup>5</sup> / <sub>8</sub>	2 <sup>1</sup> / <sub>32</sub>	32.8
22	17 <sup>1</sup> / <sub>8</sub>	4 <sup>3</sup> / <sub>16</sub>	4 <sup>17</sup> / <sub>32</sub>	3 <sup>7</sup> / <sub>16</sub>	3 <sup>3</sup> / <sub>32</sub>	1 <sup>5</sup> / <sub>32</sub>	3 <sup>5</sup> / <sub>32</sub>	7 <sup>17</sup> / <sub>32</sub>	4 <sup>1</sup> / <sub>4</sub>	2 <sup>17</sup> / <sub>32</sub>	59.5
31.5	20 <sup>5</sup> / <sub>32</sub>	4 <sup>19</sup> / <sub>32</sub>	5 <sup>3</sup> / <sub>16</sub>	3 <sup>13</sup> / <sub>16</sub>	3 <sup>7</sup> / <sub>16</sub>	1 <sup>11</sup> / <sub>32</sub>	3 <sup>23</sup> / <sub>32</sub>	8 <sup>3</sup> / <sub>4</sub>	5 <sup>3</sup> / <sub>16</sub>	3 <sup>5</sup> / <sub>32</sub>	101.4

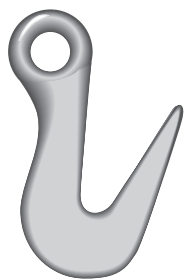

P-6731

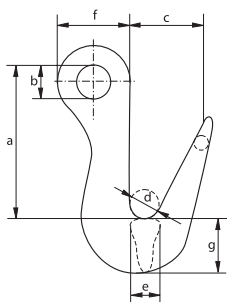

## Green Pin® pipe line hooks

for handling large cylindrical shapes like pipe lines, tubes etc.

- Material : alloy steel
- Safety factor : MBL equals 5 x WLL
- Finish : painted red
- Certification : 2.1 2.2 3.1

working load limit at hook		length	diameter eye inside	width opening	diameter	thickness	diameter eye outside	width	weight each
top	bottom	a	b	c	d	e	f	g	
t	t	mm	mm	mm	mm	mm	mm	mm	kg
2	7.5	167	35	74	30	31	73	57	2.65



P-6706A

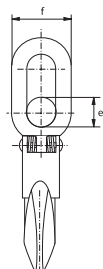
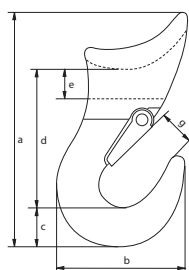

## Green Pin® sliding choker hooks, Grade 8

with safety latch

- Material : alloy steel, Grade 8
- Safety factor : MBL equals 5 x WLL
- Finish : painted red
- Certification : 2.1 2.2 3.1

working load limit	diameter rope	length	width	thickness	length	diameter	thickness	opening	weight each
t	mm	a mm	b mm	c mm	d mm	e mm	f mm	g mm	kg
0.8	6 - 11	112	63	19	65	14	30	16	0.4
1.6	10 - 13	143	82	26	83	17	30	19	0.8
2.5	14 - 16	170	98	30	97	19	33	25	1.2
3.2	16 - 20	196	115	36	110	22	40	28	1.9
5.4	22 - 26	260	142	46	145	36	60	35	4.2