

## Lashing

### Applications

Lashing items are suitable for many different lashing purposes, but may never be used for lifting.

### Range

Van Beest offers a range of S and SO hooks from 0.2 t to 6 t and a clevis lashing hook with a lashing capacity (LC ) of 4 t to 30 t.

### Design

Lashing items are designed to be used for cargo lashing during transportation. Lashing should be done securely and in accordance with the safety rules. These products are not suitable for lifting applications.

These components are generally marked with:

- |  |            |
|--|------------|
| - lashing capacity                     | ■ e.g. 2 t |
| - manufacturer's identification symbol | ■ EXCEL    |
| - traceability code                    | ■ e.g. HA  |
| - origin                               | ■ FRANCE   |

### Finish

EXCEL® lashing items are painted red.

### Certification

Specific details of certificate availability can be found on each product page. Please verify your certification requirements with Van Beest at time of order.

### Instructions for use

Items should be inspected before use to ensure that:

- all markings are legible;
- the item is not used for lifting;
- items should be used for in-line loading only;
- items are not distorted or unduly worn;
- items are free from nicks, gouges, cracks and corrosion;
- never modify, repair or reshape an item by machining, welding, heating or bending as this may affect the lashing capacity.

### INFO

For a detailed explanation on the correct (dis)assembly of clevis fittings, we refer to the instruction PI-03-06 in the FAQ section on our website.

### Inspection

It is required that the products are regularly inspected in accordance with the safety standards given in the country of use. This is required because the products in use may be affected by wear, misuse, overloading, etc which may lead to deformation and alteration of the material structure.

Inspection by a competent person should take place at least every six months and more frequently when the items are used in severe operating conditions.



S

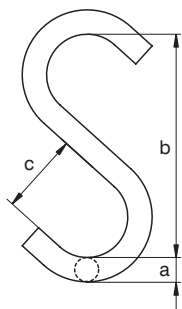

## S-Hook

- **Material** : high tensile steel
- **Safety factor** : MBL equals 4 x LC
- **Finish** : painted red
- **Certification** : 2.1 2.2

lashing capacity	diameter	length	width	weight each
t	a mm	b mm	c mm	kg
0.2	10	80	30	0.11
0.3	13	100	40	0.24
0.5	16	130	50	0.47
0.75	18	170	60	0.8
1	20	185	64	1.02
1.2	22	200	69	1.4
1.5	24	230	80	1.95
2	32	270	90	3.5
3	36	325	98	5.16
4	40	350	112	7.48
5	45	400	130	10.81
6	51	450	150	16.2



SO

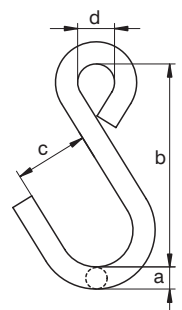

## S Eye Hook

- **Material** : high tensile steel
- **Safety factor** : MBL equals 4 x LC
- **Finish** : painted red
- **Certification** : 2.1 2.2

lashing capacity	diameter	length	width	width inside	weight each
t	a mm	b mm	c mm	d mm	kg
0.2	10	80	30	16	0.11
0.3	13	100	40	21	0.25
0.5	16	130	50	25	0.48
0.75	18	160	59	34	0.76
1	20	180	65	42	1.07
1.2	22	195	69	37	1.4
1.5	24	220	79	40	1.79
2	32	260	90	46	3.8
3	36	320	99	52	5.35
4	40	360	115	59	7.85
5	45	390	126	68	10.95
6	51	450	150	77	15.2



CAC

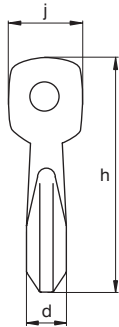
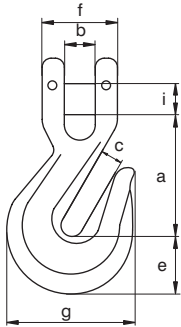

Clevis lashing hook

- **Material** : alloy steel, grade 8, quenched and tempered
- **Safety factor** : MBL equals 2 x LC
- **Finish** : painted red
- **Certification** : 2.1 2.2

for chain diameter		lashing capacity	length	width	width	thickness	width	width outside	width outside	length outside	diameter pin	width outside	weight each
mm	inch	t	a mm	b mm	c mm	d mm	e mm	f mm	g mm	h mm	i mm	j mm	kg
8	5/16	4	66	10	10	16	23	38	56	107	9	19	0.34
10	3/8	6.3	82	13	13	25	31	46	77	137	12	27	0.85
13	1/2	10	113	17	17	30	43	61	106	185	16	36	1.98
16	5/8	16	130	20	20	38	49	69	120	215	20	40	2.95
18/20	3/4	25	152	24	34	40	58	88	142	254	21	44	5.12
22	7/8	30	178	28	27	54	66	101	164	295	24	58	8.92